

191A 088E1 PERROT









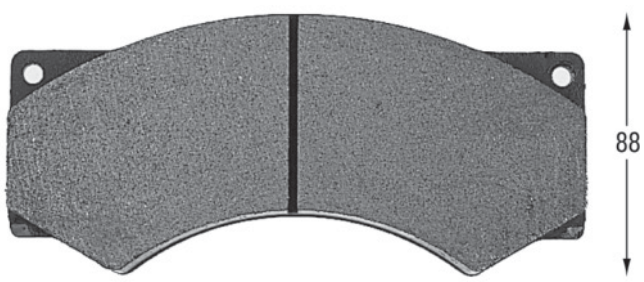

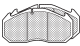

DAF/LEYLAND	F45-SERIES 	37
	ROADRUNNER 	37
DAF	1000 SERIES 	39
	F45-SERIES 	45

WVA

29017 23 4



				#
4499 ☆ ☆			541643	4

			Max 	min 	ABS 	#
	Ø 312	30 > 27			F	187079 2

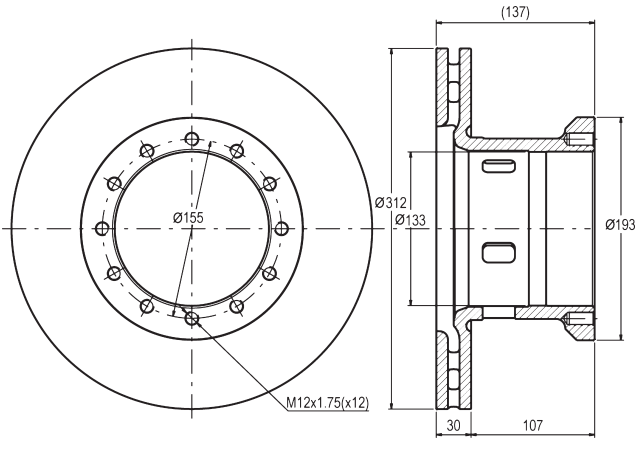

191A 088E2 PERROT









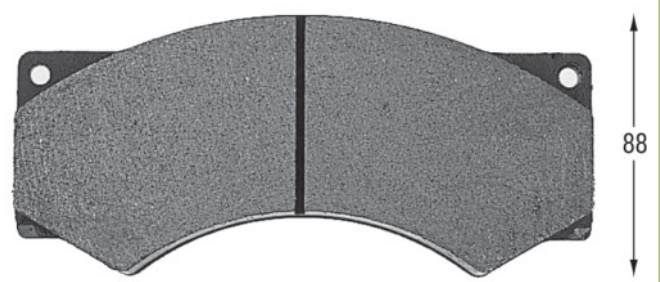

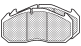



IVECO	FIAT Z-SERIES 	63
	ZETA 	68

WVA

29017 23 4



				#
4499 ☆ ☆	2 		541614	4

			Max 	min 	ABS 	#
	Ø 315	26 > 23			F	187006 2

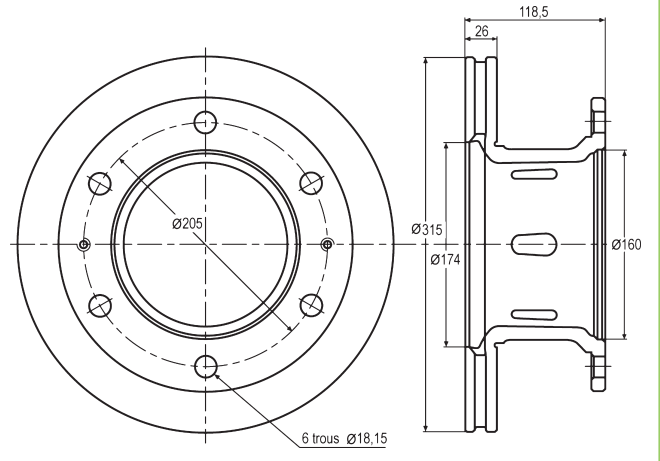



191A 088E3

PERROT



DAF/LEYLAND

F45-SERIES 37
ROADRUNNER 37

WVA



#

29017

23

4

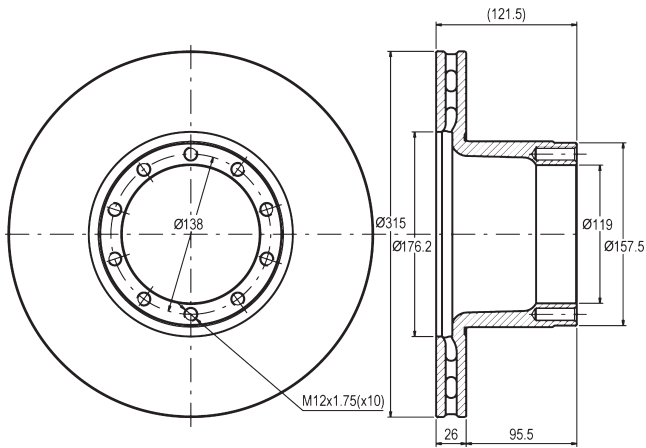
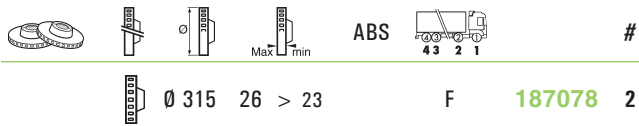
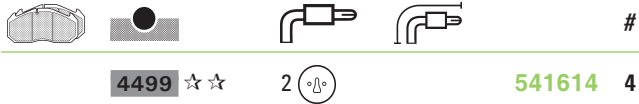
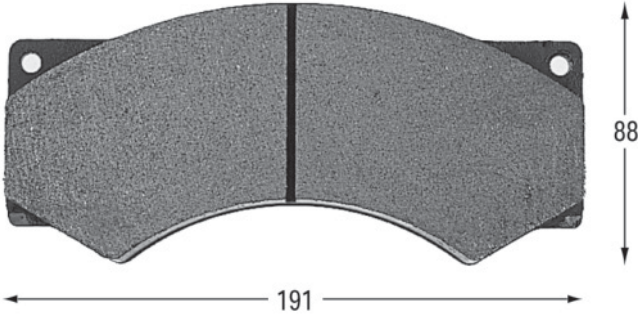

191A 088E4

PERROT



DAF/LEYLAND

F45-SERIES 37
ROADRUNNER 37

WVA



#

29017

23

4

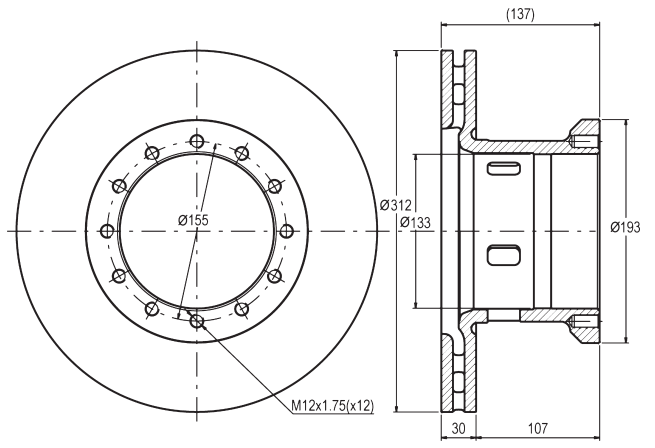
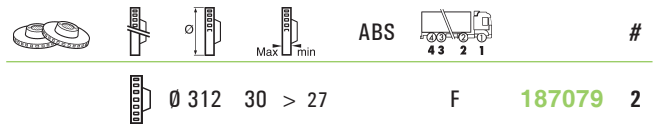
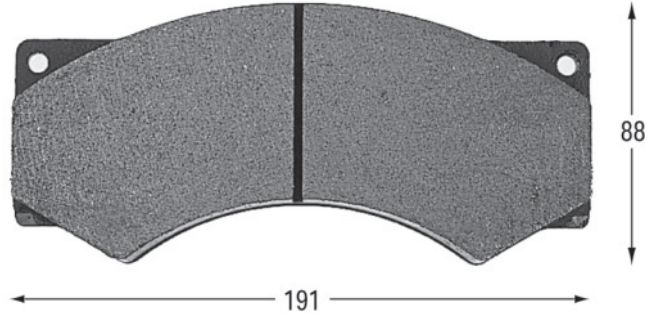



204A 097E0

LUCAS



RENAULT TRUCKS	MAGNUM/AE	161
	R	167
	R-SERIES	169

WVA

29043

24 4

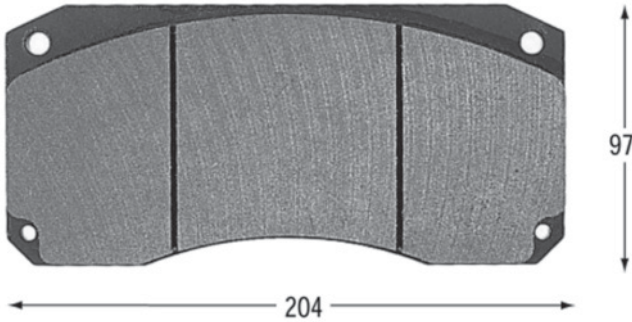

				#
4405 ☆ ☆	2Y	580	541648	4

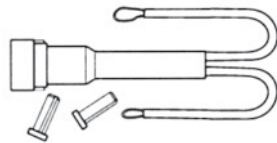

4405 ☆ ☆	2+	541605	4
----------	----	--------	---

				ABS		#
	Ø 440	44,4 > 39,4	F	187022	2	

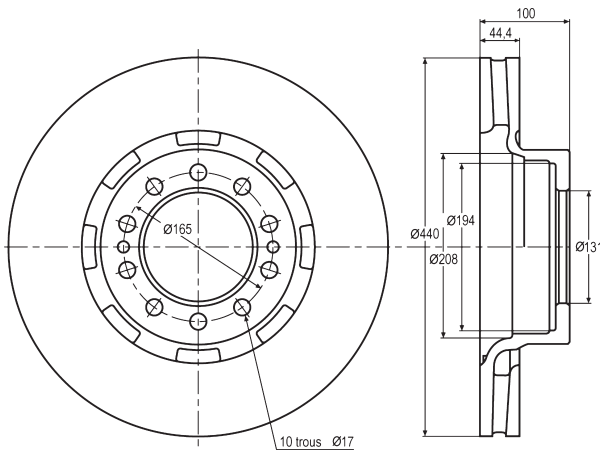

204A 097E1

LUCAS



RENAULT TRUCKS	MAGNUM/AE	161
	R	167

WVA

29043

24 4

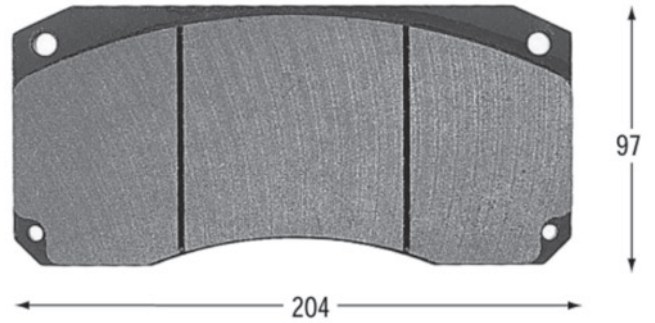

				#
4405 ☆ ☆	2Y	580	541648	4

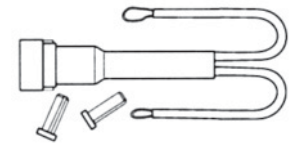

4405 ☆ ☆	2+	541605	4
----------	----	--------	---

				ABS		#
	Ø 438	45 > 41	F	187024	2	

